

# SATURN 9

Proiettore da incasso ad alta potenza per esterno, calpestabile e carrabile con fascio orientabile. Flangia in acciaio inox. Prodotto adatto ad illuminare grandi strutture architettoniche e monumentali. Ideale per illuminare colonne, facciate, viali e giardini.

*External, walk-over and drive-over floodlight with adjustable beam. Inox flange. This item is ideal for illuminating big architectures and monuments. Created to illuminate columns, facades and gardens.*



CODE: SR009 9 led

## TECHNICAL DATA

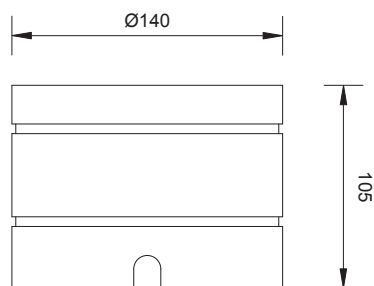
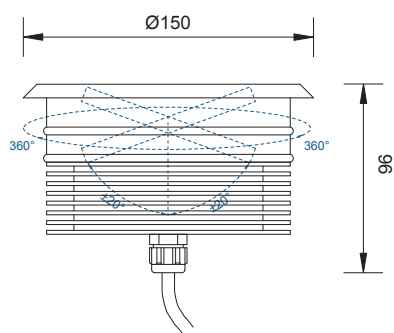

OUTER CASE

### COLOURS



RGB



AWB



A WW W

**POWER 1W**  
350 mA

**POWER 3W**  
700 mA



Cool white



Natural white



Warm white



Amber



Red



Green



Blue

**POWER 1W**  
350 mA

**POWER 2W**  
500 mA

### OPTICS

